

BallastWise®



FLUORESCENT BALLAST SPECIFICATIONS

DESCRIPTION

CATALOG NO.	TYPE	STARTING METHOD	NUMBER OF LAMPS	LAMP TYPE
DXE3HO5UD	Electronic	Program Rapid Start	3	F54T5HO PL55W, PL50W

ELECTRICAL CHARACTERISTICS

INPUT VOLTAGE	REQUENCY	LAMP WATTS	INPUT WATTS	INPUT CURRENT	THD	PF	SOUND RATED A	
120V / 277V	50/60Hz	54W, 55W, 50W	187W/36W	1.57A/0.68A	<10%	0.99		
MIN START TEMP	Class P	TYPE 1 Outdoor	BALLAST FACTOR		BEF	O.C.V.	BALLAST FREQUENCY	NO PCB'S
0°F/-18°C			1.00~0.03	0.535	300VRMS	>40kHz		

PHYSICAL CHARACTERISTICS

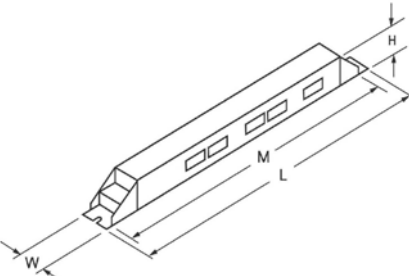
	CASE DIMENSIONS							
	UNITS	M	L	W	H			
	INCHES	16.20	16.88	2.25	1.00			
	TOL(+/-)	0.05	0.05	0.05	0.05			
CONNECTOR WIRETRIP								
COLOR	BLACK	WHITE	GREEN	RED	YELLOW	BLUE	BROWN	
NUMBER	1	1	1	2	3	4	1	

PRODUCT PHOTO

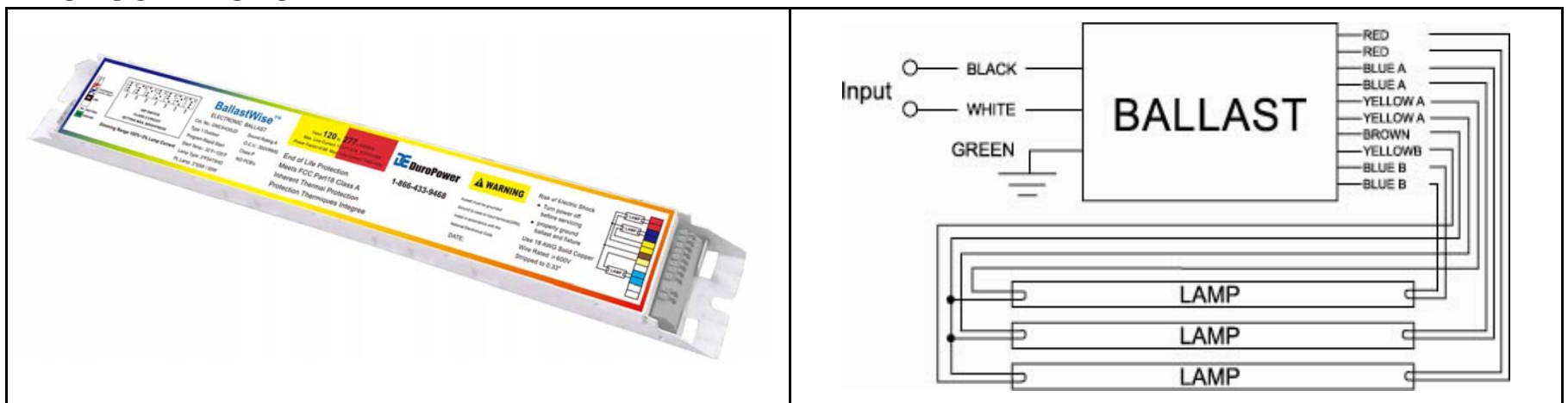

PRODUCT LABEL



PHOTOCOUPLER
CLASS 2 CIRCUIT

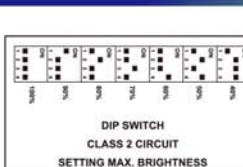

DIP SWITCH
CLASS 2 CIRCUIT
SETTING MAX. BRIGHTNESS

BallastWise™
ELECTRONIC BALLAST

Cat. No.: DXE3HO5UD Sound Rating A

Type 1 Outdoor O.C.V.: 300VRMS

Program Rapid Start Class P

Start Temp.: 32°F-120°F NO PCB'S

Lamp Type: 3°F54T5HO

PL Lamp: 3*55W / 50W

Input: 120 to 277 v 50/60Hz
Max. Line Current 1.57A 277V@0.68A
Power Factor>0.99 Max. Line Current THD<10%

DuroPower™

1-866-433-9468

End of Life Protection
Meets FCC Part18 Class A
Inherent Thermal Protection
Protection Thermiques Integree

WARNING

Risk of Electric Shock

- Turn power off before servicing
- properly ground ballast and fixture

Use 18 AWG Solid Copper
Wire Rated ≥600V
Stripped to 0.33"

